



Department of Public Service
5330 Seaman Road
Oregon, Ohio 43616
(419) 698-7047
FAX (419) 691-0241

June 11, 2021

ADDENDUM No. 3

OREGON TOWN CENTER – PHASE 1

CITY OF OREGON

DEPARTMENT OF PUBLIC SERVICE

BIDS TO BE OPENED: Thursday, June 17, 2021 at 10:00 AM

Plan holders of the City of Oregon’s Oregon Town Center – Phase 1 Project are hereby notified of the following amendments to the Contract Documents. The following additions, alterations, deletions and/or clarifications shall be part of the bid specifications as much as if they were originally included in the Contract Documents. This Addendum No. 2 is hereby made a part of the Contract Documents.

Notice to Bidders – Revised Bid Opening Date

The Bid Opening has been moved back to **10:00 am on Thursday, June 17, 2021**.

Delete and Replace the text for paragraph 1 of the **Notice to Bidders** with the following revised bid opening time:

Sealed proposals marked for “**OREGON TOWN CENTER – PHASE 1**” will be received by the City of Oregon, Ohio, at the Office of the Director of Public Service at the Oregon Municipal Building, 5330 Seaman Road, Oregon, Ohio 43616-2608, **until 10:00 A.M., local time, on Thursday, June 17, 2021**, and then opened and read aloud for furnishing the Department of Public Service with the following work:

CONTRACT CHANGES

1) PROJECT BID FORMS

Replace PAGES 18 and 19 in the Project Bid Book with the attached **REVISED BID FORM PAGES 18 and 19 Addendum #3 (Issued 6/11/21)**.

On Page 18 Pay Ref 171 and 172 have been added.

On Page 19 the **Time of Completion** has been revised to the following:

“The undersigned agrees to substantially complete the work covered by the contract for Streets “A”, “B”, “D”, “E” and Pickle Road by **June 1, 2022** and the work covered by the contract for Street “C” by **July 15, 2022** with final completion by **August 1, 2022**.”

2) PLAN REVISIONS

Replace PLAN SHEET 13 in the Plan Set with the attached **REVISED PLAN SHEETS 13 with noted Addendum 3 Changes**.

ADDENDUM No. 3
OREGON TOWN CENTER – PHASE 1

ANSWERS TO SUBMITTED QUESTIONS

1. ***Bidder Question:*** *There is no pay item that addresses the placement of the stockpiled topsoil.*

Engineer Response:

Payment for spreading of the stockpile topsoil to finished grade shall be incidental to the relevant earthwork (excavation or embankment) pay items. Restoration throughout the project construction limits shall consist of spreading four (4) inches of topsoil to the finished grade elevation shown in the plans per ODOT CMS 659.11

2. ***Bidder Question:*** *Can drums be used for maintenance of traffic overnight during the widening operation.*

Engineer Response:

See Notes and Details on Page 14 of the plans. Use of drums for the maintenance of traffic on Pickle Road is sufficient for the project as shown in the plans. Pickle Road's speed limit of 35mph is considered a low-speed MOT design condition.

***** END OF ADDENDUM NO. 3 *****



Paul Roman, P.E
Director of Public Service

162	644	REMOVAL OF PAVEMENT MARKING	144	FT		
163	644	REMOVAL OF PAVEMENT MARKING	1	EACH		
164	644	REMOVAL OF PAVEMENT MARKING	0.28	MILE		
165	SPEC	LONGITUDINAL CHANNELIZER	2	EACH		
MAINTENANCE OF TRAFFIC						
166	614	MAINTAINING TRAFFIC, AS PER PLAN	1	LS		
167	614	LAW ENFORCEMENT OFFICER WITH PATROL CAR FOR ASSISTANCE	16	HOUR	\$76.00	\$1,216.00
MISCELLANEOUS						
168	619	FIELD OFFICE, TYPE B	12	MNTH		
169	623	CONSTRUCTION LAYOUT STAKES AND SURVEYING, AS PER PLAN	1	LS		
170	624	MOBILIZATION	1	LS		
CONTINGENCY						
171	203	<i>EXCAVATION (FOR WET POND), AS PER PLAN</i>	4877	CY		
172	203	<i>EMBANKMENT, AS PER PLAN (CLAY LINER FOR WET POND), AS PER PLAN</i>	4877	CY		

TOTAL PROJECT BASE BID IN FIGURES \$ _____
(Unofficial total subject to correction)

- II. Time of Completion. The undersigned agrees to substantially complete the work covered by the contract for Streets “A”, “B”, “D”, “E” and Pickle Road by June 1, 2022 and the work covered by the contract for Street “C” by July 15, 2022 with final completion by August 1, 2022.

- III. Accompanying this Bid is a Certified Check or Bid Bond in the amount of _____ Dollars (\$ _____) , payable to the City of Oregon, Ohio, which it is agreed, shall be retained as liquidated damages to the City of Oregon, Ohio, if the undersigned fails to execute the Contract in conformity with the Form of Contract incorporated in the Contract Documents and furnish performance bond as specified within ten (10) days after notification of the award of the Contract to the undersigned.

- IV. In submitting this Bid, it is understood that the right is reserved by the City of Oregon, Ohio, to reject any and all bids. It is agreed that this Bid may not be withdrawn for a period of 60 days from the opening thereof.

The following documents are attached to and made a condition of this Bid:

- a. Non-Collusion Affidavit
- b. Acknowledgement of Income Tax Policies
- c. Affidavit of Compliance with Ohio Revised Code Section 3517.13

Bidder acknowledges receipt of the following addendum(s):

RESTORATION OF RIGHT-OF-WAY

ALL EXISTING FEATURES IN THE RIGHT OF WAY AND EASEMENT THAT ARE DISTURBED DUE TO CONSTRUCTION SUCH AS PAVEMENT, MAILBOXES, SHRUBS, BUSHES, SWALES, DRIVEWAYS, BERMS, SEEDED AREAS, ETC., SHALL BE RESTORED TO THEIR ORIGINAL CONDITION IN ACCORDANCE WITH ANY APPLICABLE ODOT AND CITY OF OREGON SPECIFICATIONS AND TO THE SATISFACTION OF THE CITY OF OREGON. ALL YARDS, BERMS AND/OR SIDE DITCHES DISTURBED DURING CONSTRUCTION SHALL BE FINE GRADED TO THEIR ORIGINAL SLOPES OR PLAN GRADE, ANY DEBRIS REMOVED AND SEEDED. SEED SHALL CONFORM TO THE FOLLOWING SPECIFICATIONS AND THEN EVENLY SOWN OVER THE PREPARED AREA AT THE RATE OF NOT LESS THAN FOUR (4) POUNDS PER 1,000 SQUARE FEET. AN APPLICATION OF AN APPROVED COMMERCIAL FERTILIZER SHALL BE APPLIED AT THE RATE OF 20 POUNDS PER 1,000 SQUARE FEET.

- 40% KENTUCKY BLUE GRASS
- 55% CREEPING RED FESCUE
- 5% RED TOP
- 1% MAXIMUM WEED CONTENT

EXCELSIOR MATTING SHALL BE USED ON SLOPES WHICH ARE GREATER THAN 3: 1 OR AS DIRECTED BY THE ENGINEER. DISTURBED AREAS, UNLESS OTHERWISE SPECIFIED, SHALL BE PREPARED, SEEDED, FERTILIZED AND MULCHED ACCORDING TO ODOT AND CITY OF OREGON SPECIFICATIONS.

REPLACE EXISTING PAVEMENTS, DRIVEWAYS, PARKING AREAS, CURBS, GUTTERS, BERM STONE, SIDEWALKS, WATER LINES, GAS LINES, SEWERS, CATCH BASINS, HEADWALLS, DRAINS, FIELD TILE, CONDUIT PIPES, CABLES, FENCES, GRASSED AREAS, AND OTHER EXISTING FACILITIES REMOVED OR OTHERWISE DISTURBED IN CARRYING OUT THE WORK IN AS GOOD A CONDITION AS FOUND AND TO THE APPROVAL OF OWNER. REPLACE EXISTING DRIVES AND PAVEMENT AS PER CITY OF OREGON DETAILS.

EXISTING MAIL BOXES AND TRAFFIC SIGNS IN THE LINE OF CONSTRUCTION SHALL BE REMOVED AND ERECTED IN TEMPORARY LOCATIONS IN A MANNER SATISFACTORY TO OWNER, AND AFTER COMPLETION OF CONSTRUCTION, MOVED TO AND RE ERECTED IN THEIR ORIGINAL LOCATIONS.

EXISTING FENCES, DECORATIVE WALLS, ADVERTISING SIGNS, AND OTHER SUCH EXISTING FEATURES IN THE LINE OF CONSTRUCTION SHALL BE REMOVED, STORED, PROTECTED, AND RE-ERECTED IN THEIR ORIGINAL LOCATIONS UNLESS OTHERWISE DIRECTED BY OWNER.

ALL MATERIALS BROKEN OR DISTURBED TO SUCH AN EXTENT AS TO REQUIRE REPLACEMENT SHALL BE REPLACED WITH NEW MATERIAL AT THE EXPENSE OF CONTRACTOR.

EXCEPTION TO THE ABOVE SHALL BE MADE IN THE CASE OF WORK AND MATERIALS FOR WHICH PAYMENT WILL BE MADE UNDER SECTIONS SUBSEQUENTLY SPECIFIED AND AT THE APPROPRIATE UNIT PRICES INCLUDED IN THE CONTRACT.

WORK AND MATERIALS SHALL BE IN ACCORDANCE WITH APPLICABLE REQUIREMENTS OF THESE CONTRACT DOCUMENTS AND, WHERE NOT INCLUDED HEREIN, THE REQUIREMENTS OF APPLICABLE ODOT ITEMS AS APPROVED BY ENGINEER.

IN ANY EVENT, CONTRACTOR SHALL BE LIABLE FOR ANY DAMAGE TO PUBLIC OR PRIVATE PROPERTY CAUSED BY MOVEMENT OF EQUIPMENT OR BY OTHER OPERATIONS AND SHALL REPAIR OR REPLACE, TO THE CONDITION EXISTENT PRIOR TO THE WORK, ANY PUBLIC OR PRIVATE PROPERTY DAMAGED BY HIS OPERATIONS.

PAYMENT FOR THIS WORK SHALL BE INCLUDED IN THE UNIT PRICE BID FOR THE PERTINENT ITEM. ALL RESTORATION OF RIGHT-OF-WAY AND EASEMENT MUST BE APPROVED BY THE CITY PRIOR TO FINAL PAYMENT FOR THIS WORK

INCIDENTALS

PRICE BID FOR THE PERTINENT CONDUIT ITEMS SHALL INCLUDE ALL WORKS AND MATERIALS NOT INCLUDED IN THE QUANTITIES BUT NECESSARY TO COMPLETE THE PROJECT IN A WORKMANLIKE MANNER INCLUDING, BUT NOT LIMITED TO, BACKFILL AND BEDDING MATERIAL, PAVEMENT REPLACEMENT, ETC.

DUNN CHEVROLET LOT ACCESS AND CONSTRUCTION SEQUENCE

1. IN GENERAL, ACCESS TO DUNN CHEVROLET MUST BE MAINTAINED FULLY FROM EITHER STREET 'A' OR STREET 'B' DURING THE ENTIRETY OF THE PROJECT. ACCESS SHALL INCLUDE CAR DELIVERY TRUCKS.
2. PREPARE THE DUNN SOUTH LOT EXTENSION FOR PAVING (BY OTHERS) PER THE SPECIFICATIONS. THE CONTRACTOR MAY USE THE RECYCLED CONCRETE STONE FROM THE FORMER KMART SITE FOR THE DUNN LOT EXPANSION. THE DUNN SOUTH ACCESS AND LOT EXTENSION SHALL BE IN OPERATION A MINIMUM OF 30 DAYS FOLLOWING THE COMPLETION OF THE STONE BASE FOR THE SOUTH LOT EXTENSION PRIOR TO BEGINNING STREET 'B' DEMOLITION. DUNN CHEVROLET WILL NEED TIME TO ALLOW FOR PAVING OF THE LOT (BY OTHERS) AND TO MOVE THEIR VEHICLES FROM THE STREET 'B' PROJECT AREA.
3. ADDITIONALLY, PRIOR TO STREET 'B' DEMOLITION, CONSTRUCT STREET 'A' FROM PICKLE ROAD UP TO THE PROPOSED DUNN SOUTH ENTRANCE, INCLUDING THE PROPOSED DRIVE APRON, IN ORDER TO ENABLE DELIVERY TRUCK ACCESS. THE CONTRACTOR SHALL MAINTAIN, AT MINIMUM, ONE-LANE, TWO-WAY TRAFFIC ON STREET 'A' FOR THE DUNN ACCESS DURING WORK HOURS. TWO-LANE, TWO-WAY TRAFFIC SHALL BE AVAILABLE DURING NON-WORK HOURS.
4. STREET 'B' RECONSTRUCTION SHALL THEN BE COMPLETED WITHIN FOURTEEN (14) CALENDAR DAYS. THIS INCLUDES PAVEMENT/CURB REMOVAL, INSTALLATION OF STORM SEWER, LIGHTING CONDUIT, NEW CURB & GUTTER, AND THE ASPHALT CONCRETE BASE (301 LAYER). THE ASPHALT INTERMEDIATE AND SURFACE COURSES CAN OCCUR LATER WITH THE PLACEMENT OF SUFFICIENT ASPHALT RAMPS FOR TEMPORARY ACCESS TO DRIVES.
5. ONCE ACCESS TO DUNN FROM STREET 'B' IS RE-ESTABLISHED, THE CONTRACTOR MAY REMOVE THE DUNN ACCESS VIA STREET 'A' FOR CONSTRUCTION OF OTHER PROJECT FEATURES.

OTHER PROJECT CONSTRUCTION SEQUENCE AND MILESTONES

1. UNINTERRUPTED ACCESS TO LOT 1 (MULTI-FAMILY UNIT LOT) VIA ITS SOUTH ENTRANCE (APPROXIMATE STREET 'A' STA. 14+50) SHALL OCCUR NO LATER THAN SEPTEMBER 17, 2021 AND REMAIN ACCESSIBLE FOR THE DURATION OF THE PROJECT.
2. ALL WORK ASSOCIATED WITH STREETS "A", "B", "D", "E" AND PICKLE ROAD MUST BE SUBSTANTIALLY COMPLETED BY June 1, 2022, EXCLUDING THE SURFACE COURSE OF ASPHALT AND FINAL PAVEMENT MARKINGS.
3. ONCE ACCESS TO CHARLES CREST FROM STREET 'B' IS ESTABLISHED, THE CONTRACTOR MAY REMOVE THE EXISTING DRIVE ON DUSTIN ROAD.

3

ITEM 203, EMBANKMENT, AS PER PLAN (SOIL FROM 3831 PICKLE TO SITE)

CONTRACTOR SHALL FURNISH TO THE SITE SPOILS MATERIAL FROM AN EXISTING CITY CONTROLLED STOCKPILE LOCATED AT 3831 PICKLE ROAD, WHICH IS APPROXIMATELY 1 MILE EAST OF THE SITE. WORK ASSOCIATED WITH THIS ITEM SHALL BE COMPLETED PRIOR TO SEPTEMBER 17, 2021.

CONTRACTOR SHALL STRIP AND STOCKPILE EXISTING 4 INCHES OF TOPSOIL FROM THE TOP OF THE MOUND PRIOR TO EXCAVATING SPOILS FROM THE STOCKPILE.

MATERIAL SHALL BE TRANSPORTED AND STOCKPILED AT THE SOUTHERN END OF LOT 1, AS DIRECTED.

FOLLOWING THE COMPLETION OF THE EXCAVATION WORK FROM THE EXISTING SPOILS MOUND, ALL DISTURBED AREAS OF THE MOUND SHALL BE RESHAPED AND REGRADED, TOPSOIL REPLACED, AND THEN PREPARED, SEEDED, FERTILIZED AND MULCHED ACCORDING TO ODOT 659. THE SEED MIXTURE SHALL BE PER ODOT CLASS 1.

PAYMENT FOR ALL OPERATIONS DESCRIBED ABOVE SHALL BE INCLUDED IN THE CONTRACT PRICE BID FOR THIS ITEM.

THE FOLLOWING QUANTITY HAS BEEN INCLUDED IN THE GENERAL SUMMARY FOR THE WORK NOTED ABOVE:

203, EMBANKMENT, AS PER PLAN (SOIL FROM 3831 PICKLE TO SITE) 8000 CY

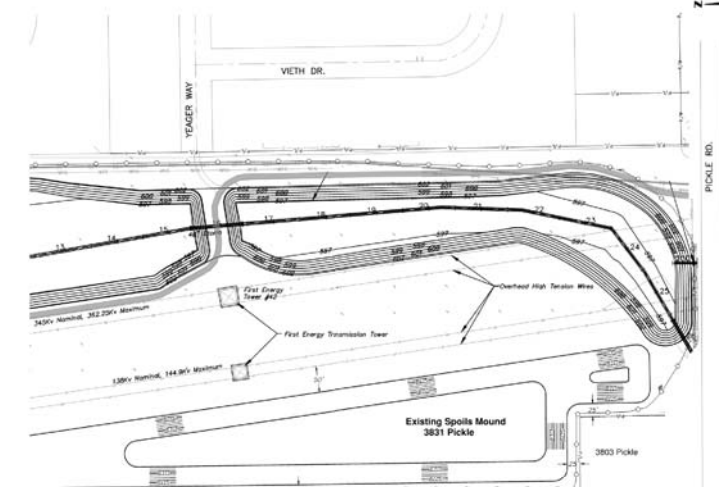

CONTINGENCY QUANTITIES

WORK LISTED IN THE GENERAL SUMMARY AS CONTINGENCY OR ITEMS DESIGNATED BY PLAN NOTE TO BE USED "AS DIRECTED BY THE ENGINEER" SHALL NOT BE PERFORMED UNLESS AUTHORIZED BY THE ENGINEER. ALTHOUGH THE CONTRACTOR MAY CHOOSE TO ORDER AND/OR PURCHASE SOME OR ALL OF THE ITEMS FOR HIS CONVENIENCE, ONLY THOSE ITEMS ACTUALLY PLACED AT THE DIRECTION OF THE ENGINEER SHALL BE INCLUDED FOR PAYMENT. THE ACTUAL WORK LOCATIONS AND QUANTITIES SHALL BE BASED UPON FINAL FIELD MEASUREMENT.