

March 28, 2022

ADDENDUM No. 2

**LUC-2-22.51 NAVARRE / COY INTERSECTION IMPROVEMENT
PID 109596**

**CITY OF OREGON
DEPARTMENT OF PUBLIC SERVICE**

BIDS TO BE OPENED: Thursday, March 31, 2022 at 2:00 PM

Plan holders of the City of Oregon's LUC-2-22.51 NAVARRE / COY INTERSECTION Improvement are hereby notified of the following amendments to the Contract Documents. The following additions, alterations, deletions and/or clarifications shall be part of the bid specifications as much as if they were originally included in the Contract Documents. This Addendum No. 2 is hereby made a part of the Contract Documents.

CONTRACT CHANGES

- 1) Delete and Replace the text for last paragraph on page 28 of the **BID PROPOSAL FORM (REVISED)** with the following revised time of completion dates:
 - II. Time of Completion. The undersigned agrees to substantially complete **all of the underground and pavement** work covered by the contract by October 28, 2022 and all completed and ready for final payment by December 30, 2022.

2) PROJECT PLAN SHEETS 12, 25 & 26

Replace PLAN SHEETS 12, 25, and 26 in the Plan Set with the **attached REVISED PLAN SHEETS 12, 25, and 26 noted "Addendum #2 (Issued 3/28/22)"**.

Notes have been added to address providing temporary streetlights, vehicle detection, pedestrian signals and push buttons (as necessary) during MOT phases.

3) PROJECT PLAN SHEET 83

ALTERNATE BID: ITEM 625 - LUMINAIRE, CONVENTIONAL SOLID-STATE (LED)-(DECORATIVE)
Per plan note on Sheet 83 in the Project Plans.

Sternberg Lighting is considered an equal to the King/Holophane specified decorative units in the plans.

1914LED LIBERTYVILLE SERIES: 1A-1914LED-1L50T4- MDL12-G-R7-PE-BKT

4) PROJECT PLAN SHEET 83

ALTERNATE BID: ITEM 632 - SIGNAL SUPPORT, (BY TYPE), (DECORATIVE)
Per plan note on Sheet 83 in the Project Plans.

Millerbernd Manufacturing is considered to be an equal to the Valmont Industries, Inc. specified Decorative Combination Traffic Signal Support Poles in the plans.

AUGUSTA (BAAR) – 16S-Flute - BEMIDJI ARM - SCROLL BRACE PART # DS1

***** END OF ADDENDUM NO. 2 *****

Rodney Shultz, P.E.
Deputy City Engineer

CONSTRUCTION SEQUENCE

STAGE 1

SET UP THE TEMPORARY TRAFFIC SIGNAL AND TRAFFIC CONTROL AS DETAILED IN THE PLANS AND PERFORM THE FOLLOWING WORK. LANE RESTRICTIONS FOR THIS STAGE SHALL NOT EXCEED 45 DAYS.

- CONSTRUCT WORK ZONE SIGNAL DURING OFF PEAK HOURS OR NIGHT TIME HOURS 9PM TO 7AM
- CONSTRUCT NORTH SIDE OF COY, INCLUDING CULVERT AND SIGNALS

-STAGE 1A

- CONSTRUCT THE WEST SIDE OF COY TO THE SOUTH OF NAVARRE AVE THROUGH THE BASE COURSE.
- CONSTRUCT 3" PAVEMENT FOR MAINTAINING TRAFFIC ON BASE TO MATCH EXISTING SURFACE ELEVATION.
- CONSTRUCT ALL SIDEWALKS, CURB RAMPS, AND DRIVEWAYS LOCATED WITHIN THE CURRENT WORK AREA
- INSTALL NEW SIGNAL EQUIPMENT FOR SW CORNER. COVER ALL NEW SIGNAL HEADS.

-STAGE 1B

- CONSTRUCT THE EAST SIDE OF COY TO THE SOUTH OF NAVARRE AVE THROUGH BASE COURSE.
- CONSTRUCT 3" PAVEMENT FOR MAINTAINING TRAFFIC ON BASE TO MATCH EXISTING SURFACE ELEVATION.
- CONSTRUCT ALL SIDEWALKS, CURB RAMPS, AND DRIVEWAYS LOCATED WITHIN THE CURRENT WORK AREA
- INSTALL NEW SIGNAL EQUIPMENT FOR SE CORNER. COVER ALL NEW SIGNAL HEADS.

STAGE 2

UPON COMPLETION OF STAGE 1 ADJUST THE WORK ZONE TRAFFIC CONTROL AS DETAILED IN THE PLANS AND PERFORM THE FOLLOWING WORK. LANE RESTRICTIONS FOR THIS STAGE SHALL NOT EXCEED 21 DAYS.

- CONSTRUCT THE WESTBOUND RIGHT TURN LANE ON NAVARRE AVE THROUGH THE BASE COURSE.

THE CONTRACTOR MAY COMPLETE STAGE 2 WORK IN CONJUNCTION WITH THE STAGE 1 CLOSURE WORK OF COY ROAD NORTH OF NAVARRE. NO TIME EXTENSIONS WILL BE ADDED TO THE 45 DAY CLOSURE PERIOD TO COMPLETE THIS WORK.

STAGE 3

UPON COMPLETION OF STAGE 2 SET UP THE TEMPORARY TRAFFIC CONTROL AS DETAILED IN THE PLANS AND PERFORM THE FOLLOWING WORK. LANE RESTRICTIONS FOR THIS STAGE SHALL NOT EXCEED 14 DAYS.

- CONSTRUCT THE RAISED MEDIAN ON NAVARRE AVE

STAGE 4

UPON COMPLETION OF STAGE 3 PERFORM THE FOLLOWING WORK.

- MILL AND RESURFACE EXISTING NAVARRE AVE AND COY RD
- APPLY FINAL SURFACE COURSE TO ALL NEW PAVEMENT SECTIONS
- COMPLETE INSTALL ALL NEW SIGNAGE
- INSTALL PAVEMENT MARKINGS
- COMPLETE SIGNAL INSTALLATION

CONTRACTOR SHALL SCHEDULE STAGE 4 WORK THROUGH THE INTERSECTIONS FOR NIGHT TIME WORK 9PM TO 7AM

ITEM 614 - MAINTAINING TRAFFIC (DURING SPECIAL EVENTS)

NO WORK SHALL BE PERFORMED AND ALL EXISTING LANES SHALL BE OPEN TO TRAFFIC DURING THE FOLLOWING DESIGNATED EVENTS:

GERMAN AMERICAN FESTIVAL - DATES (LATE AUGUST)

DROP OFFS

THE CONTRACTOR SHALL PROVIDE A 3:1 WEDGE AT ANY DROP OFF LOCATION THAT EXCEEDS 3" AT THE END OF THE WORK DAY.

ITEM 615 - PAVEMENT FOR MAINTAINING TRAFFIC, CLASS A, AS PER PLAN

THIS ITEM SHALL CONSIST OF PROVIDING ITEM 615 PAVEMENT FOR MAINTAINING TRAFFIC, CLASS A ACCORDING TO THE ODOT CONSTRUCTION AND MATERIAL SPECIFICATION EXCEPT THAT THE TOTAL THICKNESS SHALL BE 3".

Addendum #2 (Issued 3/28/22)

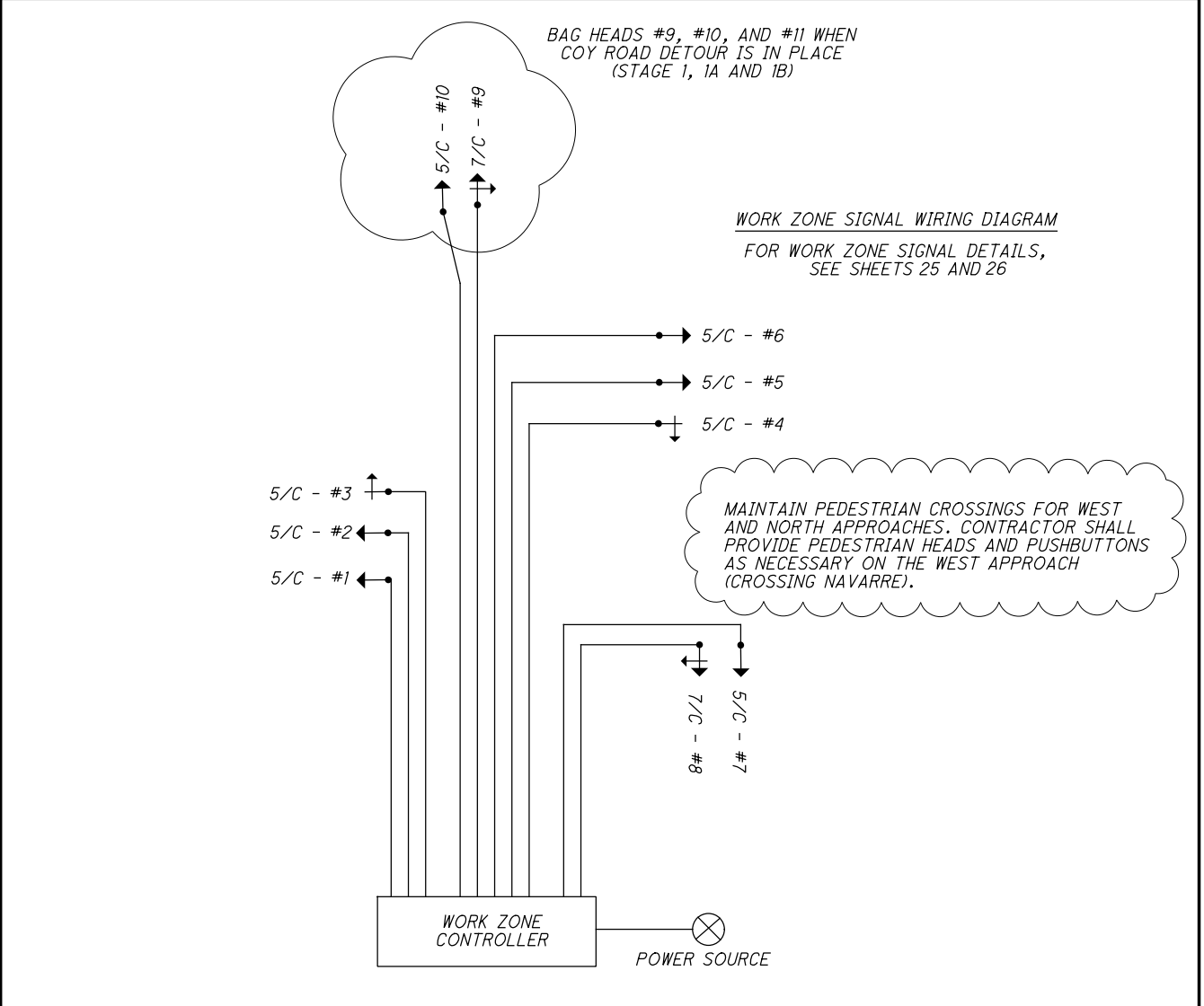

M:\19105 (City of Oregon - LUC-2-22-51\Navarre & Coy Safety Improvements)\09596.LUC-2-22-51\Design\M01\Sheet.s\09596.MN002.dgn Sheet 3/28/2022 12:48:44 PM CMS

MOT SIGNAL PLAN
PHASE 1A

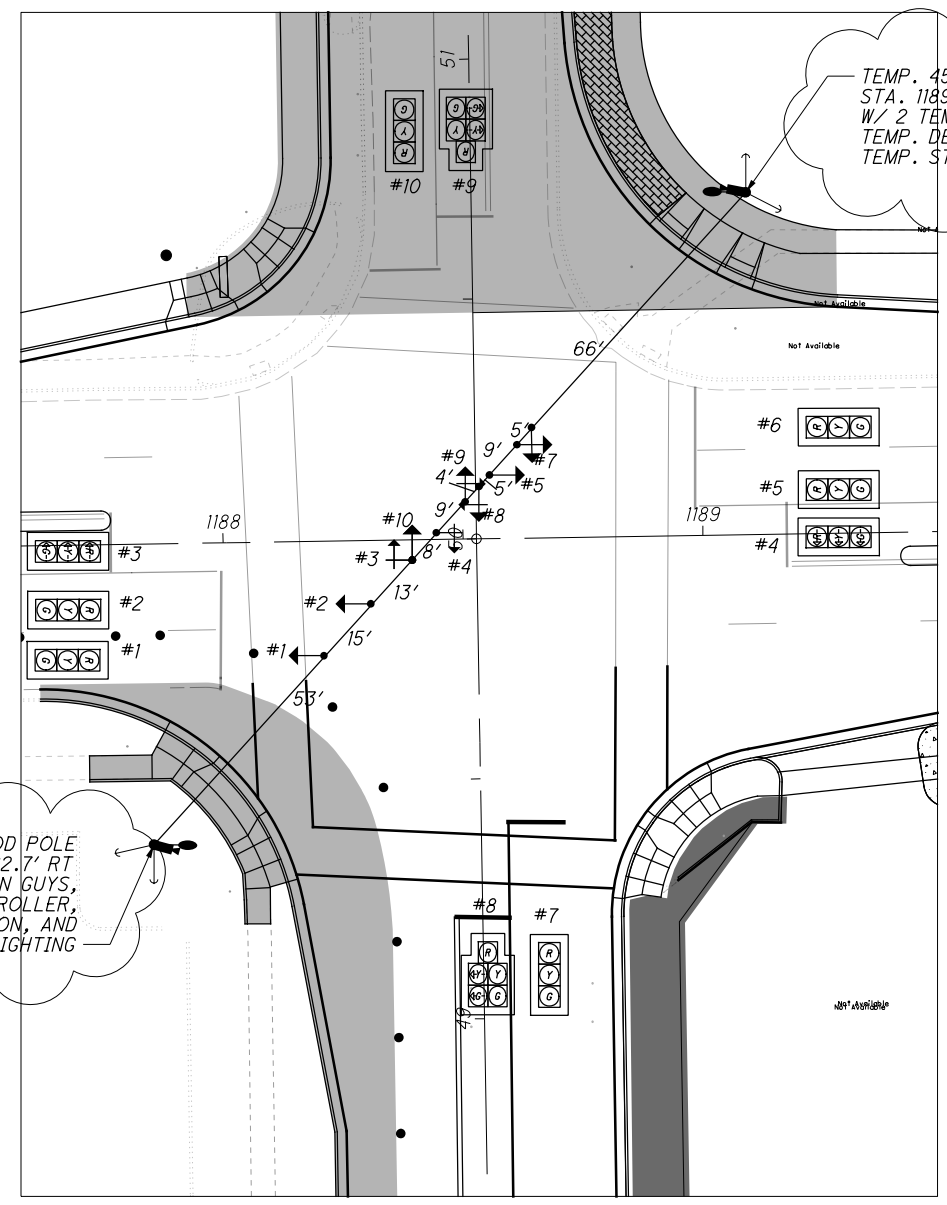

MOT SIGNAL PLAN
PHASE 1B

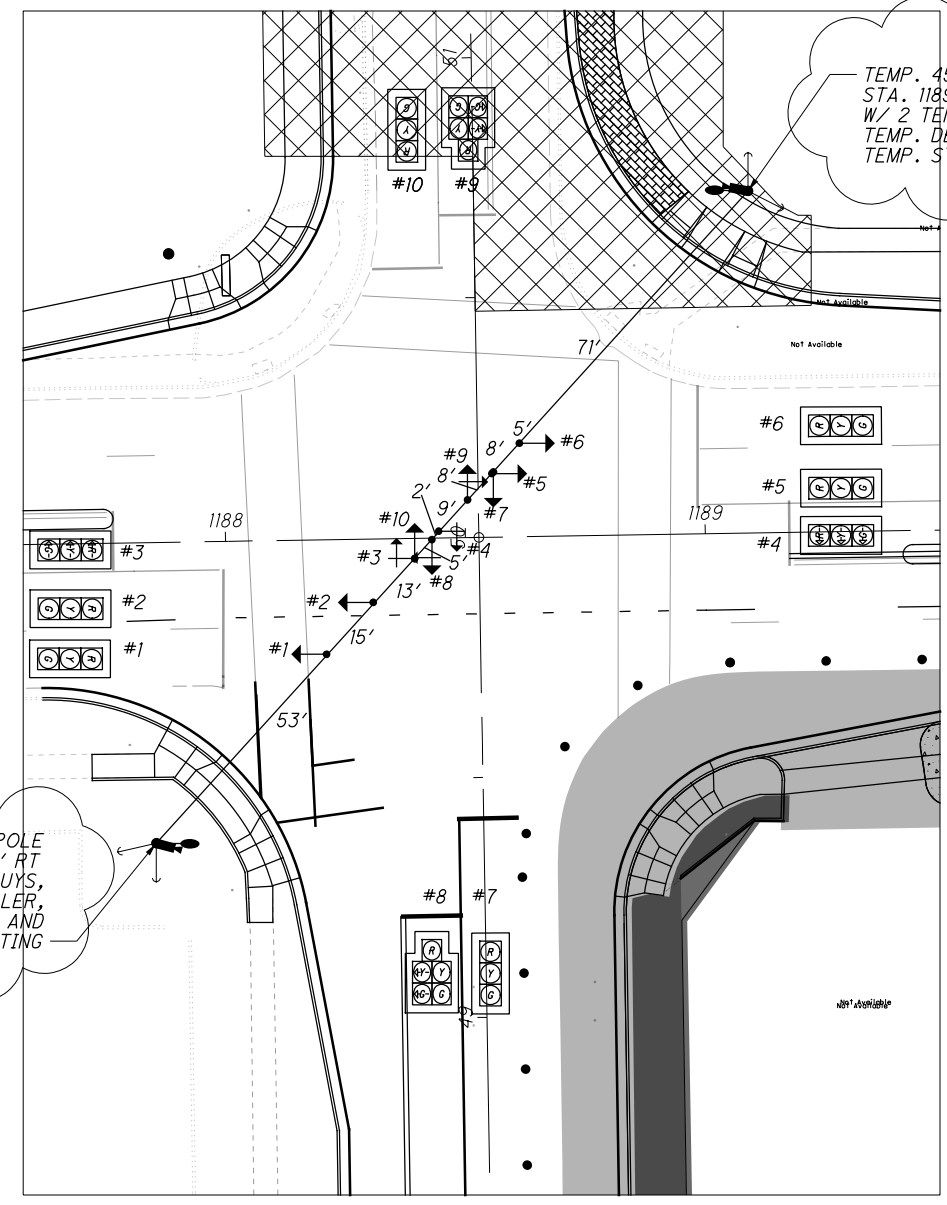

MOT SIGNAL PHASING FOR MOT PHASE 1A & 1B

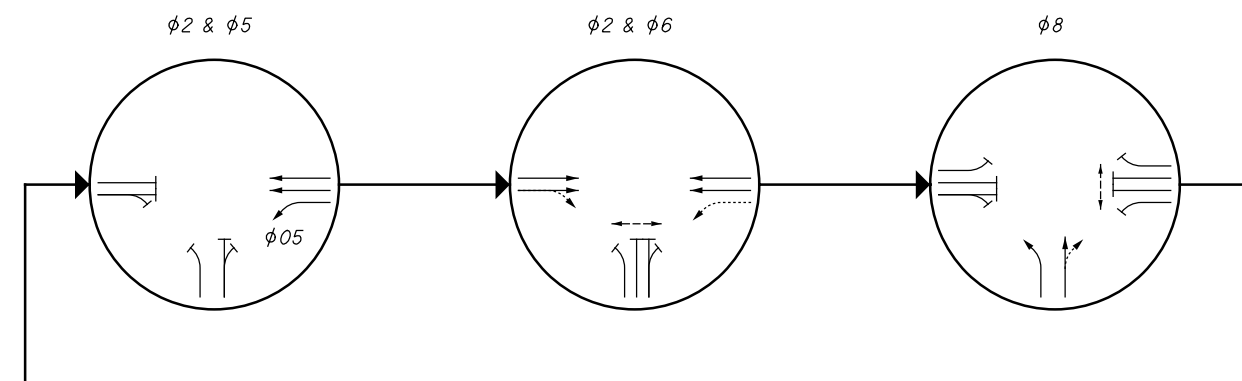

INSTALL WOOD POLES & GUYS
INSTALL MESSENGER WIRE
INSTALL WORK ZONE CONTROLLER,
VEHICULAR SIGNAL HEADS, AND SIGNAL CABLE
COVER HEADS #3, #9, AND #10 FOR PHASES 1A & 1B

FOR WORK ZONE SIGNAL
WIRING DIAGRAM, SEE SHEET 12

MAINTAIN PEDESTRIAN CROSSINGS FOR WEST AND NORTH APPROACHES. CONTRACTOR SHALL PROVIDE PEDESTRIAN HEADS AND PUSHBUTTONS AS NECESSARY ON THE WEST APPROACH (CROSSING NAVARRE).

M:\19105 (City of Oregon - LUC-2-22.51)Navarre & Coy Safety Improvements\109596.LUC-2-22.51\Design\MOT\Sheets\109596_MD002.dgn Sheet 3/28/2022 2:16:00 PM CMS

Addendum #2 (Issued 3/28/22)



MOT SIGNAL PLAN
PHASE 2

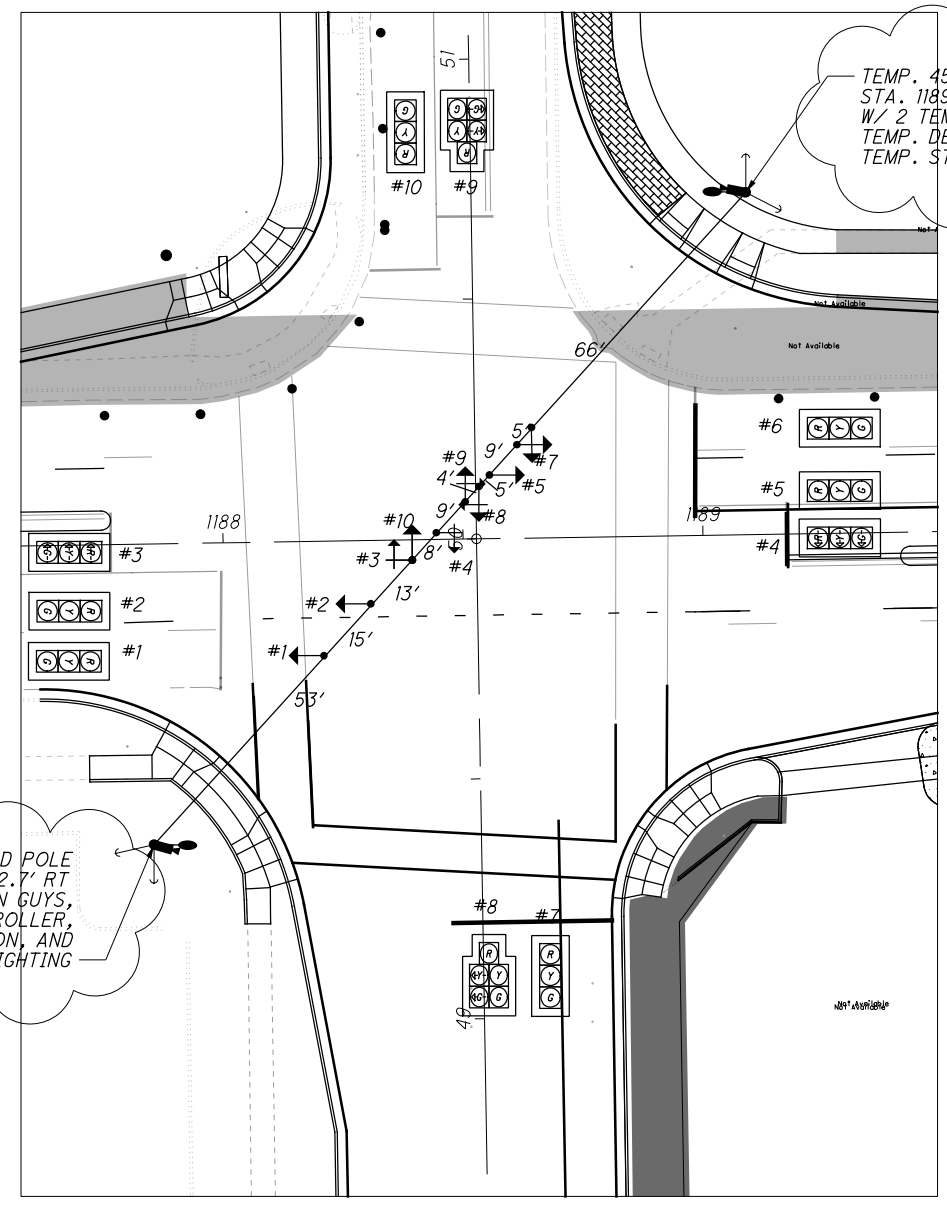

MOT SIGNAL PLAN
PHASE 3

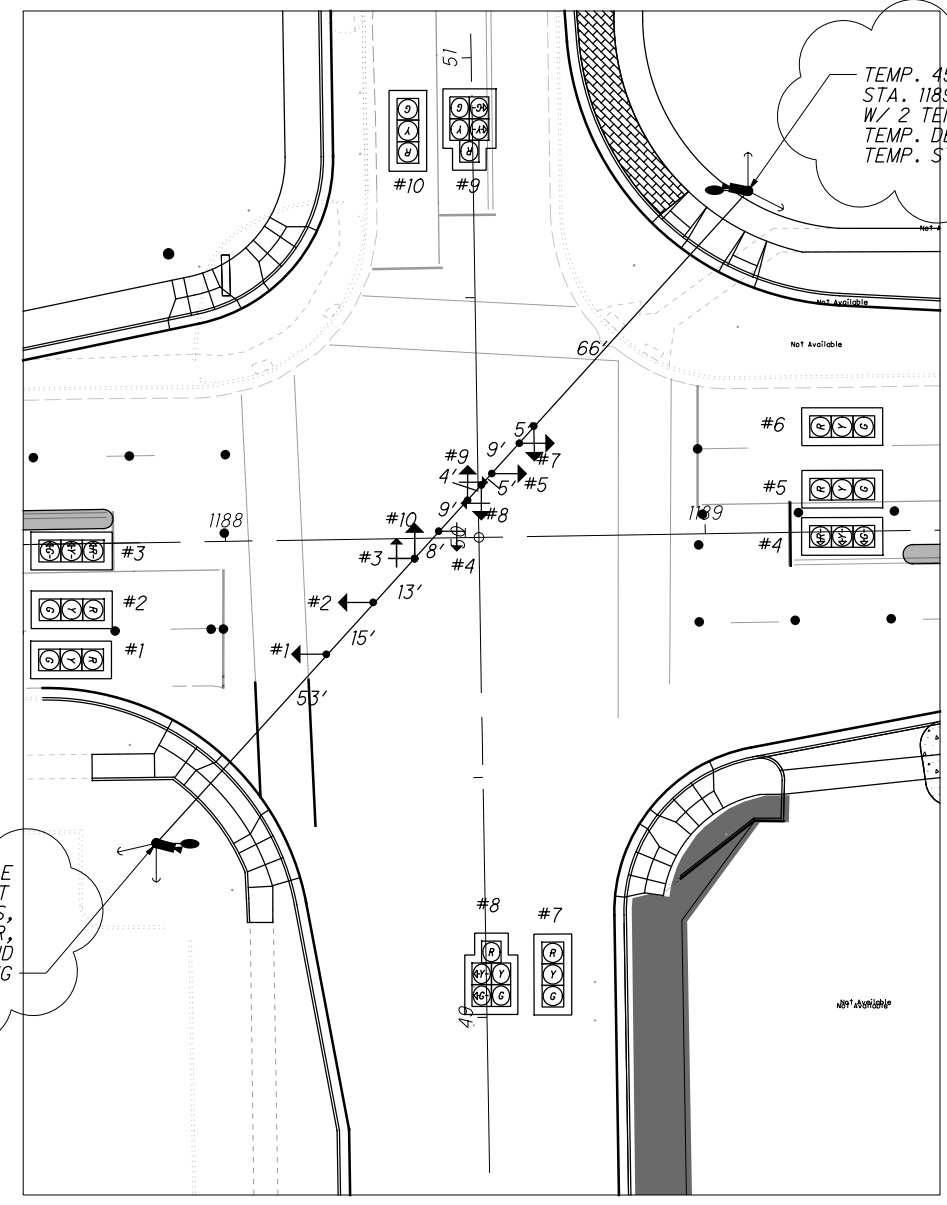

MOT SIGNAL PHASING FOR MOT PHASE 2 & 3

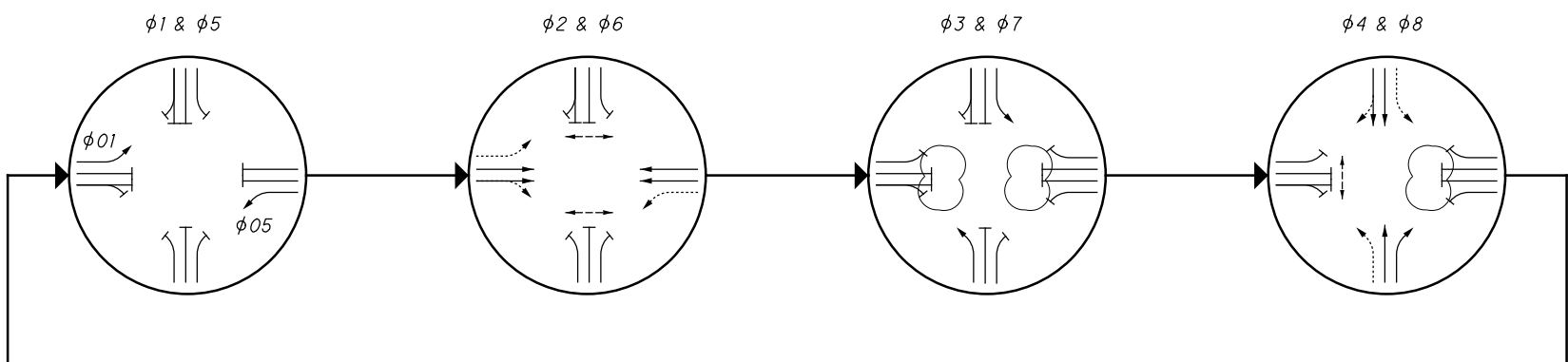

FOR WORK ZONE SIGNAL
WIRING DIAGRAM, SEE SHEET 12

MAINTAIN PEDESTRIAN CROSSINGS FOR WEST AND NORTH APPROACHES. CONTRACTOR SHALL PROVIDE PEDESTRIAN HEADS AND PUSHBUTTONS AS NECESSARY ON THE WEST APPROACH (CROSSING NAVARRE).

M:\19105 (City of Oregon - LUC-2-22-51)Navarre & Coy Safety Improvements\109596.LUC-2-22-51\Design\MOT\Sheets\109596_MD0003.dgn Sheet 3/28/2022 2:16:01 PM CMS

MAINTENANCE OF TRAFFIC
WORK ZONE TRAFFIC SIGNAL

LUC-2-22-51